

BSS

Single Ended Beam Load Cell



Description

BSS is a stainless steel Single ended beam type Load Cell, BSS is a Low Profile Hermetically-Sealed Type Structure that makes it compatible with platform, hopper, tank scales and a variety of other scales.

Features

- ▶ Pressure-type
- ▶ Stainless Steel
- ▶ Hermetically sealed structure
- ▶ Designed according to IP68

Option

- ▶ TW Bolt Type Accessory (250kgf~2tf / 3~5tf)
- ▶ TWE Ball Type Accessory (250kgf~2tf / 3~5tf)
- ▶ BCEP-EXP / Intrinsic Safety (Ex ia IIC T4)
- ▶ BCEP-EXP-D / Flameproof (Ex d IIC T6)
- ▶ BCEP-EXP-TD / Dust-proof (Ex tD A21 T135C IP66)
- ▶ OIML C3 Approved (OIML R60)
- ▶ NTEP Class III 5000 Approved

Application

- ▶ Platform Scale
- ▶ Tank, Hopper Scale

Specifications

Capacity(R.L.)	kgf	500, 1K, 2K, 3K, 5K	
Rated Output	mV / V	2.0 ± 0.005	
Zero Balance	mV / V	0.0 ± 0.02	
Accuracy Class	-	C3	-
Non-Linearity	% R.O.	≤ 0.025	≤ 0.03
Hysteresis	% R.O.	≤ 0.025	≤ 0.03
Combined Error	% R.O.	≤ 0.025	≤ 0.03
Repeatability	% R.O.	≤ 0.01	≤ 0.01
Creep for 30min.	% R.O.	≤ 0.017	≤ 0.03
Return for 30min.	% R.O.	≤ 0.017	≤ 0.03
Resolution	-	≤ 1/4000	≤ 1/3000
Division	mV / V	0.005	0.0067
Temperature Effect on	-Zero Value	%/10°C	≤ 0.014
	-Output Value	%/10°C	≤ 0.011
Excitation	-Recommended	V	10
	-Maximum	V	15
Resistance	-Input	Ω	350 ± 3.5
	-Output	Ω	350 ± 3.5
	-Insulation	MΩ	> 2000
Compensated Temperature Range	°C	-10 to +40	
Operating Temperature Range	°C	-30 to +80	
Material & Plate	-	Stainless steel	
Cable Specification	-	Ø5.4 x 4P x 5m (Urethane)	
Safety Overload	% R.L.	150.	

Dimensions

▶ BSS

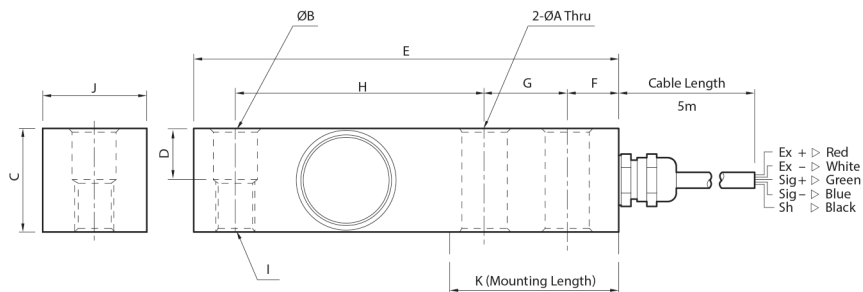

Capa.	A	B	C	D	E	F	G	H	I	J	K	Cable (m)
500kgf-2tf	13.5	13.5	31.7	15.8	130	15.8	25.4	76.1	M12 x 1.75	31.7	57	5
3~5tf	20	20	38.1	19.1	171.5	19	38.1	95.3	M18 x 1.5	38.1	76.1	

Single Ended Beam
Noise Resistance
Explosion Proof
Digital
Accessory