

DES-B

Double Ended Beam Load Cell

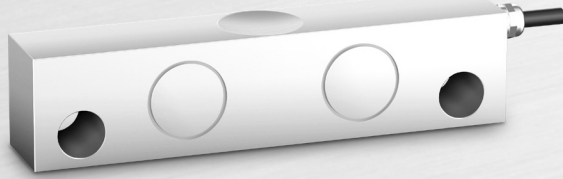

Description

DES-B is double ended type loadcell, and is suitable for high capacity hopper and tank scale and truck scale. Also through the ball, the force structure makes minimum side force.

Specifications

Capacity(R.L.)	tf	5, 10, 15, 20	
Rated Output	mV / V	2.0 ± 0.005	
Zero Balance	mV / V	0.0 ± 0.03	
Accuracy Class	-	-	
Non-Linearity	% R.O.	≤ 0.03	
Hysteresis	% R.O.	≤ 0.03	
Combined Error	% R.O.	≤ 0.03	
Repeatability	% R.O.	≤ 0.03	
Creep for 30min.	% R.O.	≤ 0.03	
Return for 30min.	% R.O.	≤ 0.03	
Resolution	-	≤ 1/3000	
Division	mV / V	0.00067	
Temperature Effect on	-Zero Value	%/10°C	≤ 0.03
	-Output Value	%/10°C	≤ 0.015
Excitation	-Recommended	V	10
	-Maximum	V	15
Resistance	-Input	Ω	800 ± 40
	-Output	Ω	700 ± 7
	-Insulation	MΩ	> 2000
Compensated Temperature Range	°C	-10 to +40	
Operating Temperature Range	°C	-30 to +80	
Material & Plate	-	Steel	
Cable Specification	-	Ø8 x 4P x 10m (PVC)	
Safety Overload	% R.L.	150% R.L.	

Features

- ▶ Robust design and easy installation
- ▶ Strong against shock or side force
- ▶ Designed according to IP67

Option

- ▶ Accessory Set

Accessory Features

- ▶ Easy loadcell replacement
- ▶ Appropriate for tank and truck scale application
- ▶ High resolution by use of ball

Application

- ▶ Hopper, Tank Scale
- ▶ Tank Scale

Dimensions

- ▶ DES-B

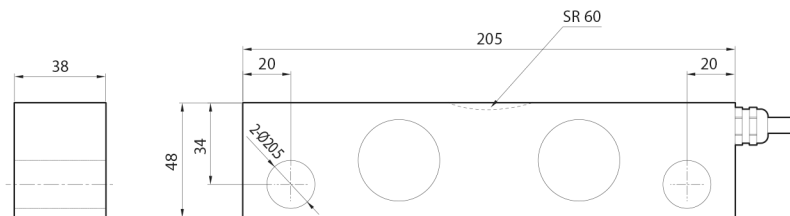

Accessory Dimensions

► DES-B

