

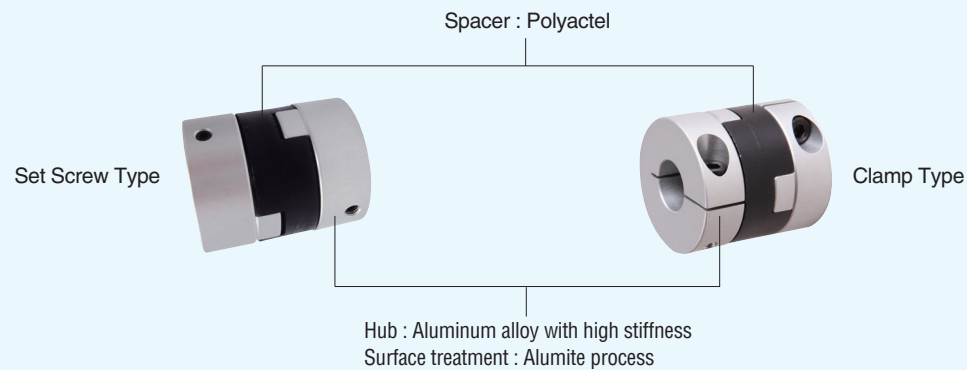

Features

- Compact type with the hole length is short.
- Bigger eccentricity and declination allowed as Hub and space are slipped.
- Less shaft load caused by misalignment, So reduce to force to the shaft.
- Absorbs the angularity which is easy for protrusion.
- Absorption vibration and electric insulation.
- It is easy to assemble (easy replacement).
- Usable temperature is $-20^{\circ}\text{C} \sim 80^{\circ}\text{C}$

Structure & material



Usage

- Servo motor
- Stepping motor
- General wide use motor
- Encoder

Others

- All products are included set screw and cap screw.
- We can supply nonstandard Inner Diameter and key seat.
- We encourage h7 for tolerance of Inner Diameter.
- We can penetrate into spacer.

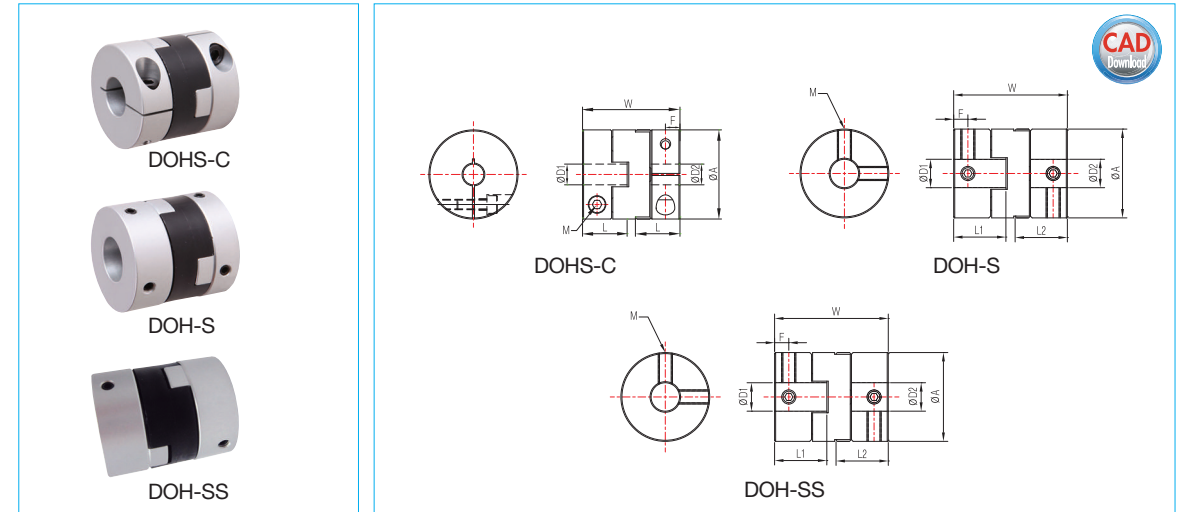

Product NO.	Dimension(mm)				Tightening Screw		Rated Torque	Max. Torque	Max. RPM	Moment of Inertia	Torsional Stiffness	Angle	Parallel	End Play	Mass	
	A	L		W	F	M										Torque
		L1	L2													
DOHS-12C	12	7	14.9	2.5	M2	0.5	0.2	0.4	52,000	7.1×10^{-8}	9	2	0.6	0.1	3	
DOHS-16C	16	9.5	20.8	3.2	M2.5	1	1	2	39,000	3.2×10^{-7}	65	2	1	0.1	8	
DOHS-20C	20	10.2	22.5	3.3	M2.5	1	1.5	3	31,000	8.2×10^{-7}	120	2	1.5	0.1	14	
DOHS-25C	25	12.2	27	3.9	M3	2	2.5	5	25,000	2.6×10^{-6}	200	2	2	0.1	25	
DOHS-32C	32	16	35	4.75	M4	4	7	14	19,000	8.3×10^{-6}	620	2	2.5	0.2	48	
DOHS-43C	43	21.5	47	7	M5	8	15	30	15,000	2.0×10^{-5}	1,200	2	3	0.2	120	
DOHS-53C	53	24.5	53	8.5	M5	8	25	50	12,000	9.6×10^{-5}	1,400	2	3.2	0.2	215	
DOHS-57C	57	25	55	8	M6	13	36	72	10,000	1.3×10^{-4}	2,600	2	4	0.2	235	
DOHS-70C	73	37	77	12.5	M8	30	65	130	7,000	4.5×10^{-4}	4,800	2	4	0.2	450	
DOH-16S	16	8.1	10.9	20.8	2.5/3.9	M3	0.7	1	2	39,000	2.7×10^{-7}	65	2	1	0.1	10
DOH-20S	20	9	11.7	22.8	2.7/4	M4	1.7	1.5	3	31,000	9.0×10^{-7}	120	2	1.5	0.1	14
DOH-25S	25	11.5	14.7	28.8	3.6/5.2	M4	1.7	2.5	5	25,000	2.6×10^{-6}	200	2	2	0.1	23
DOH-32S	32	14.5	21	38.5	4/7.25	M5	4	7	14	19,000	1.1×10^{-5}	620	2	2.5	0.2	41
DOH-16SS	16	10.9	10.9	23.6	3.9	M3	0.7	1	2	39,000	2.3×10^{-7}	65	2	1	0.1	8
DOH-20SS	20	11.7	11.7	25.5	4	M4	1.7	1.5	3	31,000	8.9×10^{-7}	120	2	1.5	0.1	14
DOH-25SS	25	14.7	14.7	32	5.2	M4	1.7	2.5	5	25,000	1.8×10^{-6}	200	2	2	0.1	23
DOH-32SS	32	21	21	45	7.25	M5	4	7	14	19,000	9.5×10^{-6}	620	2	2.5	0.2	41

Mass and Moment of inertia are measured with max bore size.

Product NO.	Standard Inner diameter(D1, D2) (mm)																						
	3	4	5	6	6.35	8	9.525	10	12	14	15	16	18	19	20	22	24	25	25.4	28	30	32	35
DOH□-12□	•	•	•																				
DOH□-16□	•	•	•	•																			
DOH□-20□		•	•	•	•	•																	
DOH□-25□			•	•	•	•	•	•															
DOH□-32□				•	•	•	•	•	•	•													
DOH□-43□						•	•	•	•	•	•	•	•	•	•								
DOH□-53□								•	•	•	•	•	•	•	•	•	•	•					
DOH□-57□									•	•	•	•	•	•	•	•	•	•	•	•			
DOH□-70□											•	•	•	•	•	•	•	•	•	•	•	•	•