

DR300F

Order method

DR300F-20×25

Product No. d D



Features

No need extra design because of the standardized product.

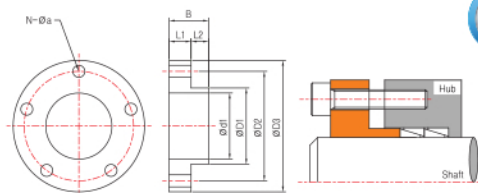

Usage : Applicable to DR300 and DR300C type.

Specifications : Shaft diameter $\varnothing 10\text{--}\varnothing 100$

DR300F d×D	Application DR300/DR300C d×D	Dimension									Tightening screw (DIN912/12.9)		Mass
		d1	D1	D2	D3	L1	L2	B	N-Øa		Size	Quantity	
mm	mm	mm	mm	mm	mm	mm	mm	mm	N	mm	M	Qty	kg
10×13	10×13	10.2	12.8	28	36	8	5	13	3	4.4	M4	3	0.06
11×14	11×14	11.2	13.8	28	36	8	5	13	3	4.4	M4	3	0.06
12×15	12×15	12.2	14.8	28	36	8	5	13	3	4.4	M4	3	0.06
13×16	13×16	13.2	15.8	28	36	8	5	13	3	4.4	M4	3	0.06
14×18	14×18	14.2	17.8	35	45	10	8	18	3	5.5	M5	3	0.12
15×19	15×19	15.2	18.8	35	45	10	8	18	3	5.5	M5	3	0.12
16×20	16×20	16.2	19.8	35	45	10	8	18	3	5.5	M5	3	0.12
17×21	17×21	17.2	20.8	35	45	10	8	18	3	5.5	M5	3	0.12
18×22	18×22	18.2	21.8	35	45	10	8	18	3	5.5	M5	3	0.12
19×24	19×24	19.2	23.8	40	50	10	8	18	4	5.5	M5	4	0.14
20×25	20×25	20.2	24.8	40	50	10	8	18	4	5.5	M5	4	0.14
22×26	22×26	22.2	25.8	40	50	10	8	18	4	5.5	M5	4	0.14
24×28	24×28	24.2	27.8	45	55	10	8	18	4	5.5	M5	4	0.16
25×30	25×30	25.2	29.8	45	55	10	8	18	4	5.5	M5	4	0.16
28×32	28×32	28.2	31.8	45	55	10	8	18	4	5.5	M5	4	0.18
30×35	30×35	30.2	34.8	50	60	10	8	18	5	5.5	M5	5	0.18
32×36	32×36	32.2	35.8	50	60	10	8	18	5	5.5	M5	5	0.19
35×40	35×40	35.2	39.8	58	68	10	8	18	6	5.5	M5	6	0.23
36×42	36×42	36.2	41.8	58	68	10	8	18	6	5.5	M5	6	0.23
38×44	38×44	38.2	43.8	58	68	10	8	18	6	5.5	M5	6	0.27
40×45	40×45	40.2	44.8	62	74	12	10	22	6	6.6	M6	6	0.31
42×48	42×48	42.2	47.8	62	74	12	10	22	6	6.6	M6	6	0.35
45×52	45×52	45.2	51.8	70	82	12	10	22	8	6.6	M6	8	0.36
48×55	48×55	48.2	54.8	70	82	12	10	22	8	6.6	M6	8	0.37
50×57	50×57	50.2	56.8	70	82	12	10	22	8	8.8	M8	8	0.38
55×62	55×62	55.2	61.8	78	90	12	10	22	8	8.8	M8	8	0.42
56×64	56×64	56.2	63.8	86	102	16	10	26	6	8.8	M8	6	0.73
60×68	60×68	60.2	67.8	86	102	16	10	26	6	8.8	M8	6	0.77
63×71	63×71	63.2	70.8	92	108	16	10	26	6	8.8	M8	6	0.82
65×73	65×73	65.2	72.8	92	108	16	10	26	6	8.8	M8	6	0.85
70×79	70×79	70.3	78.7	98	114	16	12	28	8	8.8	M8	8	0.90
71×80	71×80	71.3	79.7	98	114	16	12	28	8	8.8	M8	8	0.90
75×84	75×84	75.3	83.7	104	120	16	12	28	8	8.8	M8	8	0.96
80×91	80×91	80.3	90.7	110	130	20	12	32	10	11	M10	10	1.45
85×96	85×96	85.3	95.7	116	136	20	12	32	12	11	M10	12	1.53
90×101	90×101	90.3	100.7	120	140	20	12	32	12	11	M10	12	1.56
95×106	95×106	95.3	105.7	126	146	20	12	32	12	11	M10	12	1.7
100×114	100×114	100.3	113.7	134	154	20	12	32	12	13	M12	12	1.9

LOCKING ELEMENT