

# DSB-D | Double Ended Beam Digital Load Cell



## Description

The DSB-D digital load cell is suitable for large-scale scales such as car weighers, tanks and hoppers, Nickel plated steel IP67 construction for accurate and precise performance in harsh environments Output. The user can connect the load cells individually through the digital output, When weighing system is manufactured, it is easy to calibrate weight and calibrate, check for trouble, replace load cell It's easy to do.

## Specifications

Capacity(R.L.)	tf	10, 20, 25, 30
Rated Output	counts	300,000
Zero Balance	counts	± 300
Non-Linearity	% R.O.	< 0.015
Hysteresis	% R.O.	< 0.015
Combined Error	% R.O.	< 0.015
Repeatability	% R.O.	< 0.01
Creep for 30min.	% R.O.	< 0.017
Temperature Effect on	- Zero Value - Output Value	% R.O./10°C % R.O./10°C
Compensated Temperature Range	°C	-10 ~ +40
Operating Temperature Range	°C	-30 ~ +80
Excitation	- Minimum - Recommended - Maximum	V V V
Insulation	MΩ	≥ 2,000
Safety Overload	% R.C.	150
Material & Plate	-	Steel
Communication Method	-	RS-485 (2wire)
Communication Speed	kbit/sec	19.2
Max Cable Length for Communication	m	1,000
Warm-up Time from Cold Start	minutes	15
Asynchronous Interface Baudrate	Baud	9,600 ~ 115,200
Number of bus addresses	-	Max. 32

## Features

- ▶ Compression type
- ▶ High resolution digital output
- ▶ CE Approved
- ▶ Designed according to IP67

## Option

- ▶ Ball type accessory
- ▶ Option plate (When using DSB Analog)

## Application

- ▶ Hopper, Tank Scale
- ▶ Tank Scale

## Dimensions

▶ DSB-D

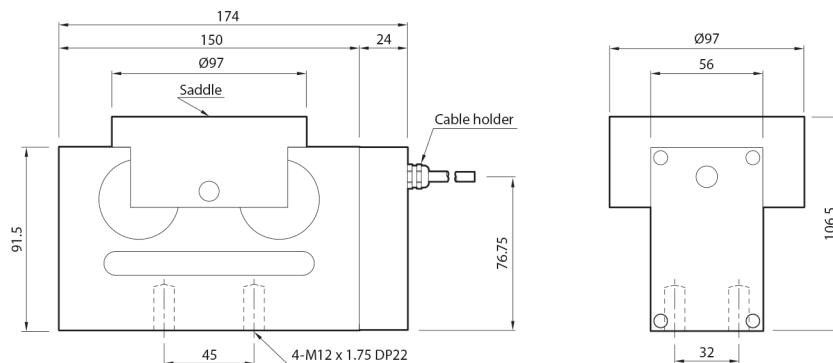

Accessory Dimensions

► DSB-D

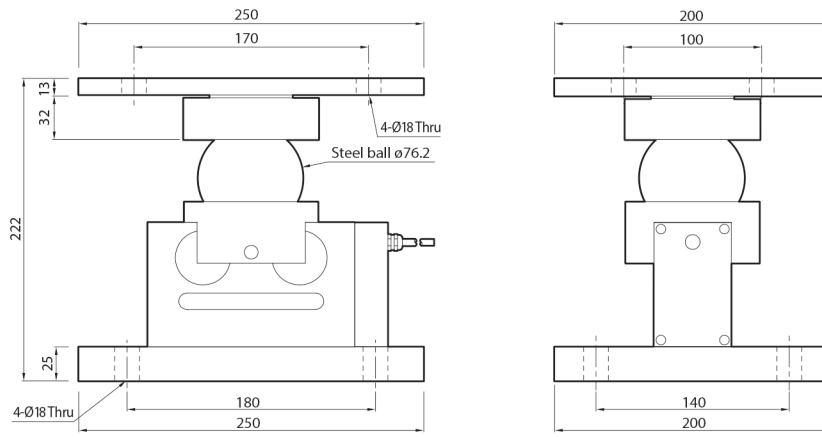

► Including base option (same height as Analog DSB type)

