

# DSB-20 | Double Ended Beam Load Cell

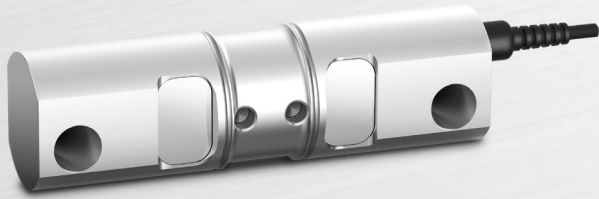

## Description

DSB-20 is double ended type loadcell, and is possible to control the hopper or tank's movement, which is located on each side of the loadcell. Also, excellent performance in the high capacity weighing system and is suitable for hopper and tank scale.

## Specifications

Capacity(R.L.)		tf	20
Rated Output		mV / V	2.0 ± 0.004
Zero Balance		mV / V	0.0 ± 0.02
Accuracy Class		-	-
Non-Linearity	% R.O.		≤ 0.03
Hysteresis	% R.O.		≤ 0.03
Combined Error	% R.O.		≤ 0.03
Repeatability	% R.O.		≤ 0.01
Creep for 30min.	% R.O.		≤ 0.03
Return for 30min.	% R.O.		≤ 0.03
Resolution	-		≤ 1/3000
Division	mV / V		0.00067
Temperature Effect on	-Zero Value	%/10°C	≤ 0.03
	-Output Value	%/10°C	≤ 0.015
Excitation	-Recommended	V	10
	-Maximum	V	15
Resistance	-Input	Ω	800 ± 40
	-Output	Ω	700 ± 7
	-Insulation	MΩ	> 2000
Compensated Temperature Range	°C		-10 to +40
Operating Temperature Range	°C		-30 to +80
Material & Plate			Steel
Cable Specification			Ø8 x 4P x 15m (PVC)
Safety Overload	% R.L.		150% R.L.

## Features

- ▶ Rocker pin loading design
- ▶ Truck scale accessory
- ▶ Designed according to IP67

## Option

- ▶ Accessory Set

## Application

- ▶ Hopper, Tank Scale

## Dimensions

- ▶ DSB-20

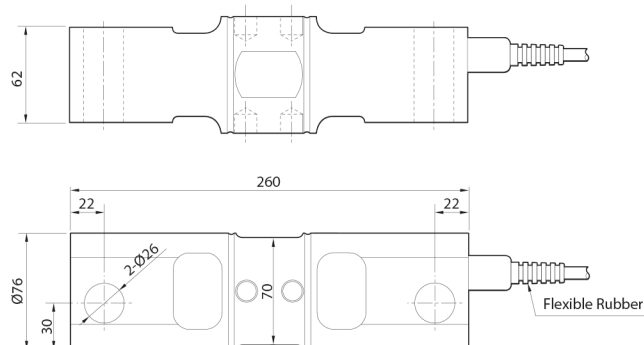

Accessory Dimensions

► DSB-20

