



Product Selection





	Contact Form	Rated Load	Built-in Switch	Certification	Material	Wire Inlet And Outlet Holes	Degree of Protection	Part Number
	1a+1b 2a+2b	15A 250VAC RES. (KC criterion)	Z15G-10B(CE, UL, CUL, CCC, KC certified)	 (Built-in Switch)	Aluminum Die-casting	1/2 Inch Tap, the flexible cable can be attached (zinc connector 10 ~ 16)	IP65	KAF-HD3T KAF-HD3T2C
	(1a+1b)x2ea (2a+2b)x2ea	15A 250VAC RES. (KC criterion)	Z15G-10B(CE, UL, CUL, CCC, KC certified)	 (Built-in Switch)	Aluminum Die-casting	1/2 Inch Tap, the flexible cable can be attached (zinc connector 10 ~ 16)	IP65	KAF-HD3T2 KAF-HD3T22C
	(1a+1b)x3ea (2a+2b)x3ea	15A 250VAC RES. (KC criterion)	Z15G-10B(CE, UL, CUL, CCC, KC certified)	 (Built-in Switch)	Aluminum Die-casting	1/2 Inch Tap, the flexible cable can be attached (zinc connector 10 ~ 16)	IP65	KAF-HD3T3 KAF-HD3T32C
	1a+1b 2a+2b	16A 250VAC RES. (KC criterion)	V type Micro Switch (CE, UL, CUL, VDE, CQC, KC certified)	 (Built-in Switch) (Built-in Switch)	Aluminum Die-casting	1/2 Inch Tap, the flexible cable can be attached (zinc connector 10 ~ 16)	IP65	KAF-HD3TV KAF-HD3TV2C
	(1a+1b)x2ea (2a+2b)x2ea	16A 250VAC RES. (KC criterion)	V type Micro Switch (CE, UL, CUL, VDE, CQC, KC certified)	 (Built-in Switch) (Built-in Switch)	Aluminum Die-casting	1/2 Inch Tap, the flexible cable can be attached (zinc connector 10 ~ 16)	IP65	KAF-HD3TV2 KAF-HD3TV2C
	(1a+1b)x3ea (2a+2b)x3ea	16A 250VAC RES. (KC criterion)	V type Micro Switch (CE, UL, CUL, VDE, CQC, KC certified)	 (Built-in Switch) (Built-in Switch)	Aluminum Die-casting	1/2 Inch Tap, the flexible cable can be attached (zinc connector 10 ~ 16)	IP65	KAF-HD3TV3 KAF-HD3TV3C

※ Please refer to 53p, 65p for additional specifications of Z15G-10B, V15F-01C.

Foot Switched

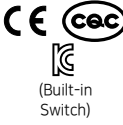
KAF-HD3 Series

Product Selection

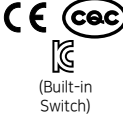
	Contact Form	Rated Load	Built-in Switch	Certification	Material	Wire Inlet And Outlet Holes	Degree of Protection	Part Number
	1a+1b 2a+2b	16A 250VAC RES. (KC)	Bolt V type Micro Switch (CE, VDE, KC certified)	 (Built-in Switch)	Aluminum Die-casting	1/2 Inch Tap, the flexible cable can be attached (zinc connector 10 ~ 16)	IP65	KAF-HD3TVB KAF-HD3TVB2C
	(1a+1b)x2ea (2a+2b)x2ea	16A 250VAC RES. (KC)	Bolt V type Micro Switch (CE, VDE, KC certified)	 (Built-in Switch)	Aluminum Die-casting	1/2 Inch Tap, the flexible cable can be attached (zinc connector 10 ~ 16)	IP65	KAF-HD3T2VB KAF-HD3T2VB2C
	(1a+1b)x3ea (2a+2b)x3ea	16A 250VAC RES. (KC)	Bolt V type Micro Switch (CE, VDE, KC certified)	 (Built-in Switch)	Aluminum Die-casting	1/2 Inch Tap, the flexible cable can be attached (zinc connector 10 ~ 16)	IP65	KAF-HD3T3VB KAF-HD3T3VB2C



※ Please refer to 53p, 65p for additional specifications of Z15G-10B, V15F-01C.

제품구분도

	Contact Form	Rated Load	Built-in Switch	Certification	Material	Wire Inlet And Outlet Holes	Degree of Protection	Part Number
	1a+1b 2a+2b	15A 250VAC RES. (KC)	Z15G-10B(CE, UL, CUL, CCC, KC certified)		Aluminum Die-casting	1/2 Inch Tap, the flexible cable can be attached (zinc connector 10 ~ 16)	IP65	KAF-HD3TF(L) KAF-HD3TF(L)2C
	(1a+1b)x2ea (2a+2b)x2ea	15A 250VAC RES. (KC)	Z15G-10B(CE, UL, CUL, CCC, KC certified)		Aluminum Die-casting	1/2 Inch Tap, the flexible cable can be attached (zinc connector 10 ~ 16)	IP65	KAF-HD3TF2 KAF-HD3TF22C
	(1a+1b)x3ea (2a+2b)x3ea	15A 250VAC RES. (KC)	Z15G-10B(CE, UL, CUL, CCC, KC certified)		Aluminum Die-casting	1/2 Inch Tap, the flexible cable can be attached (zinc connector 10 ~ 16)	IP65	KAF-HD3TF3 KAF-HD3TF32C
	1a+1b	16A 250VAC RES. (KC)	V type Micro Switch (CE, UL, CUL, VDE, CQC, KC certified)		Aluminum Die-casting	1/2 Inch Tap, the flexible cable can be attached (zinc connector 10 ~ 16)	IP65	KAF-HD3TF(L)V KAF-HD3TF(L)V2C
	(1a+1b)x2ea (2a+2b)x2ea	16A 250VAC RES. (KC)	V type Micro Switch (CE, UL, CUL, VDE, CQC, KC certified)		Aluminum Die-casting	1/2 Inch Tap, the flexible cable can be attached (zinc connector 10 ~ 16)	IP65	KAF-HD3TF2V KAF-HD3TF2V2C
	(1a+1b)x3ea (2a+2b)x3ea	16A 250VAC RES. (KC)	V type Micro Switch (CE, UL, CUL, VDE, CQC, KC certified)		Aluminum Die-casting	1/2 Inch Tap, the flexible cable can be attached (zinc connector 10 ~ 16)	IP65	KAF-HD3TF3V KAF-HD3TF3V2C

※ Please refer to 53p, 65p for additional specifications of Z15G-10B, V15F-01C.

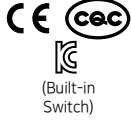
제품구분도

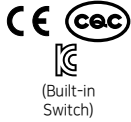
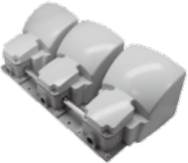
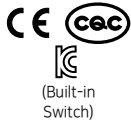
	Contact Form	Rated Load	Built-in Switch	Certification	Material	Wire Inlet And Outlet Holes	Degree of Protection	Part Number
	1a+1b 2a+2b	16A 250VAC RES. (KC)	Bolt V type Micro Switch (CE, VDE, KC certified)	 (Built-in Switch)	Aluminum Die-casting	1/2 Inch Tap, the flexible cable can be attached (zinc connector 10 ~ 16)	IP65	KAF-HD3TF(L)VB
	(1a+1b)x2ea (2a+2b)x2ea	16A 250VAC RES. (KC)	Bolt V type Micro Switch (CE, VDE, KC certified)	 (Built-in Switch)	Aluminum Die-casting	1/2 Inch Tap, the flexible cable can be attached (zinc connector 10 ~ 16)	IP65	KAF-HD3TF2VB
	(1a+1b)x3ea (2a+2b)x3ea	16A 250VAC RES. (KC)	Bolt V type Micro Switch (CE, VDE, KC certified)	 (Built-in Switch)	Aluminum Die-casting	1/2 Inch Tap, the flexible cable can be attached (zinc connector 10 ~ 16)	IP65	KAF-HD3TF3VB

※ Please refer to 53p, 65p for additional specifications of Z15G-10B, V15F-01C.

Dimension

Unit : mm

KAF-HD3T / HD3TV / HD3TVB

KAF-HD3T2 / HD3T2V / HD3T2VB

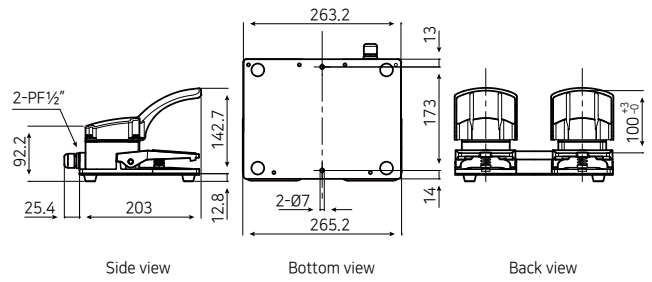
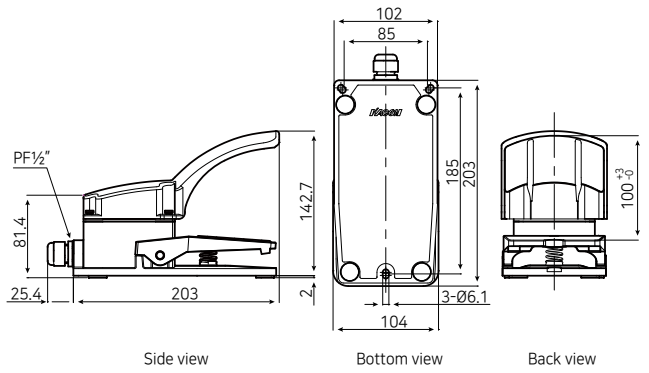

KAF-HD3T3 / HD3T3V / HD3T3VB

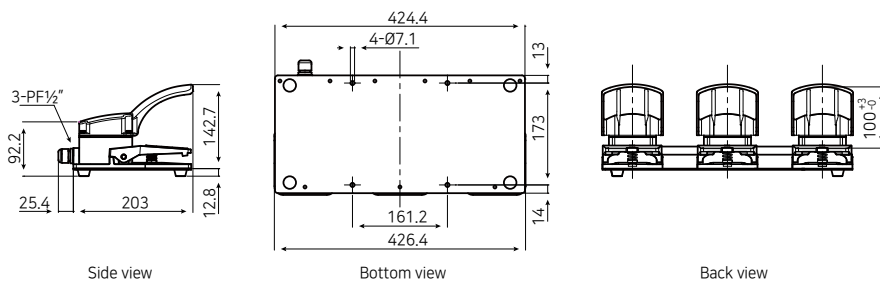

KAF-HD3TF(L) / HD3TF(L)V / HD3TF(L)VB

KAF-HD3TF2 / HD3TF2V / HD3TF2VB

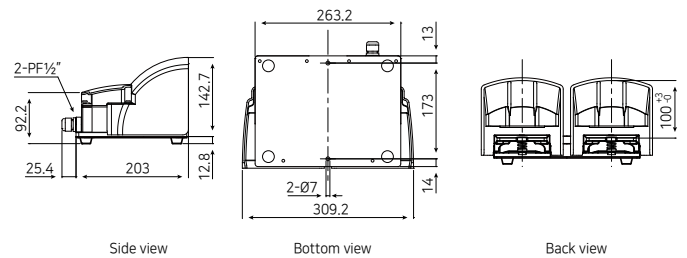
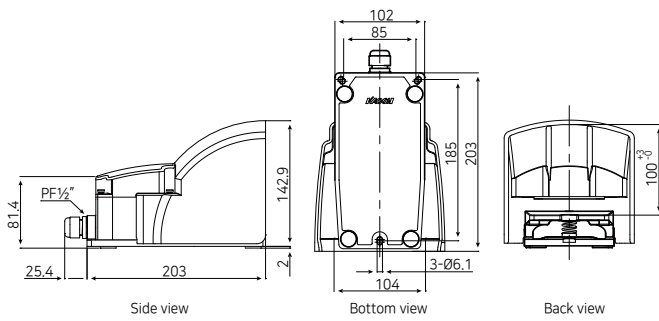

KAF-HD3TF3 / HD3TF3V / HD3TF3VB

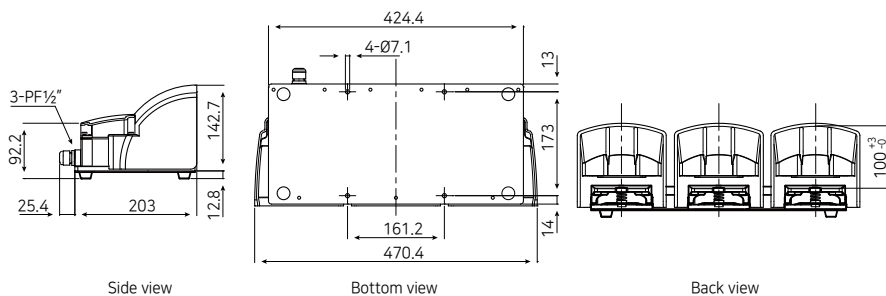

Rev. 2/14

Data subject may change without notice.

www.kacon.co.kr

Industrial Controls Catalog

III - 7