

Signal Phone

KSP Series, 41/42/43 Series, 61/62 Series



CE

Part Number Description

KSP	-	1	2	3	4
1 Sound		4 : 4 Sound		6 : 16 Sound	
2 Supply Voltage		1 : 110/220VAC 50/60Hz	2 : 12/24VDC	3 : 100 ~ 125VDC (KSP-4 series only)	4 : 48VDC (KSP-4 series only)
3 KSP-4 Type		S : Melody Variation	T : Beep-Sound Tempo Variation		
KSP-6 Type (Speaker Size)		L : □72mm	S : □48mm		
4 Color (KSP-6 Type Only)		S : Silver	K : Black		

General Specification

Size	L : □72mm	S : □48mm
Power Consumption	Max. 5W	
Maximum Sound Level	80 ~ 90dB(Phon) 1m / alterable	80 ~ 85dB(Phon) 1m / alterable
Life Cycle	Min. 1,000hrs	
Color	silver, black	
Ambient Temperature	-10 ~ +60°C	
Tightening Torque	0.5N·m (5.1kgf·cm)	
Degree of Protection	KSP-4 Series : IP65	KSP-6 Series : IP54







Note) In case of S Type speaker, life may be shortened when energized continuously for a long time.

41/42/43/44 Series

61/62 Series

KSP-4□S		KSP-4□T		Mode 1(00) ■■		Mode 2(01) ■■		Mode 3(10) ■■		Mode 4(11) ■■	
K1	Ambulance	Fast tempo ambulance		K1	Fast	Continuous	Space gun	Highly intermittent			
K2	Patrol	Slow tempo		K2	Slow	Intermittent	Phone ringtone	Highly continuous			
K3	Telephone	High tone telephone		K3	Do-re-mi	Ambulance	School bell	Splash splash			
K4	'Stepping stone' song	Low tone 'stepping stone' song		K4	Jingle bell	Batter entrance	Stepping stones	Siloam			

Product Selection

Description	110VAC / 220VAC	12VDC / 24VDC	100 ~ 125VDC	48VDC
 Melody Variation	KSP - 41S	KSP - 42S	KSP - 43S	KSP - 44S
 Beep-Sound Tempo Variation	KSP - 41T	KSP - 42T	KSP - 43T	KSP - 44T
 Small Silver	KSP - 61SS	KSP - 62SS	-	-
 Small Black	KSP - 61SK	KSP - 62SK	-	-
 Large Silver	KSP - 61LS	KSP - 62LS	-	-
 Large Black	KSP - 61LK	KSP - 62LK	-	-

Dimension

unit : mm

41/42/43/44 Series

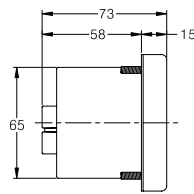
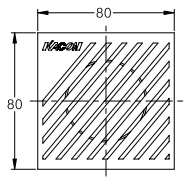

Mountain Insulation

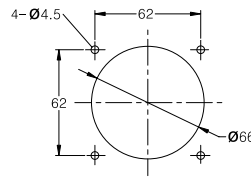

Wire Diagram

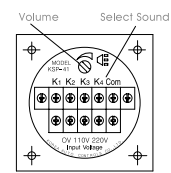

61S, 62S Series

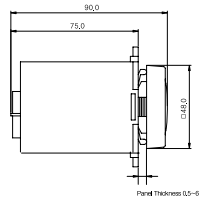

61L, 62L Series

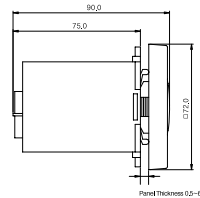

Mountain Insulation

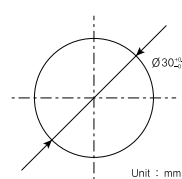

Wire Diagram

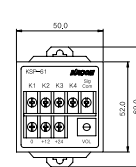

Accessory

KSP-Bracket

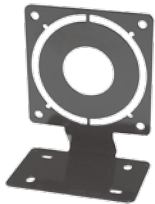

Bracket (for mounting on the exposed surface)

1

KSP-C

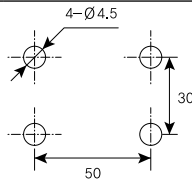

2



3



Insert the front part (speaker) in the panel or bracket

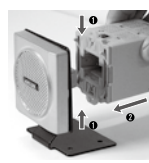

Push the device body in the horizontal arrow direction to attach it to the front part. Push the yellow stopper in the up and down arrow directions to maintain the locking state.



Fully mounted state.
[Note] Do not apply excessive force for mounting the device in process 2. The device may be broken.

Volume control

The volume can be easily controlled using a small driver.
Left direction: volume down
Right direction: volume up

Sound selection

Shift the dip switch on the side to the required position (Mode 1 ~ Mode 4).
Cut off the input power during the mode setting.

Caution

1. The signal input circuit of the signal phone has com terminals as follows.

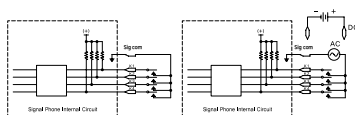

2. Set the tone using relays and switches.

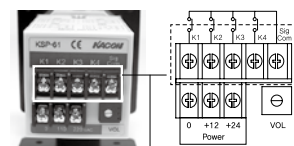

Signal input terminal

Pay attention to the polarity (+, -) for the DC type (KSP-62). Wrong polarity setting leads to non-operation and damage to the device.

3. Never apply the external power to the signal input terminals (K1, K2, K3, K4 and sig com). It may be the cause of damage to the device.

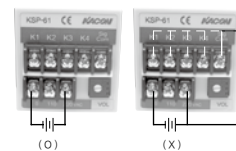

(O)

(X)

4. Be sure to cut off the input power when resetting the tone mode. Otherwise, an error or abnormal sound may occur.