

Thermostat

KTS & KTC Series



Part Number Description

KTS & KTC



① Temperature range	30 : -30°C ~ 30°C	50 : 0°C ~ 50°C	90 : 0°C ~ 90°C
	120 : 0°C ~ 120°C (KTS only)	200 : 0°C ~ 200°C (KTS only)	300 : 50°C ~ 300°C (KTS only)

General Specification

Rated Current	16A 250VAC	Model	Range	Tolerance	On/Off Difference
Control Temperature Range	-30°C ~ +300°C	KTS-30 KTC-30	-30°C ~ 30°C	±2.5K	2°C ~ 7°C
Life Cycle	Min. 100,000 hrs	KTS-50 KTC-50	0°C ~ 50°C	±3K	2°C ~ 9°C
Dielectric Strength	2,500V/1min.	KTS-90 KTC-90	0°C ~ 90°C	±3K	2°C ~ 9°C
Insulation Resistance	Min. 50MΩ	KTS-120	0°C ~ 120°C	±4K	2°C ~ 10°C
Contact Resistance	Max. 30mΩ	KTS-200	0°C ~ 200°C	±4K	2°C ~ 10°C
		KTS-300	50°C ~ 300°C	±10K	5°C ~ 30°C

Dimension

unit : mm

KTS

KTC

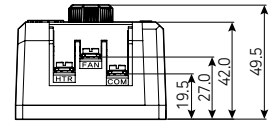
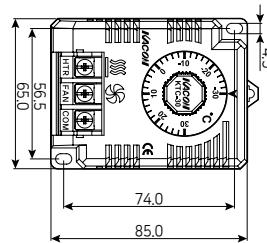
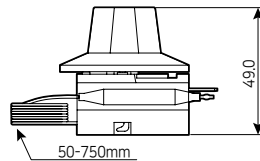
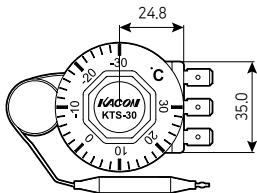

Diagram

Heater + fan

Heater

fan

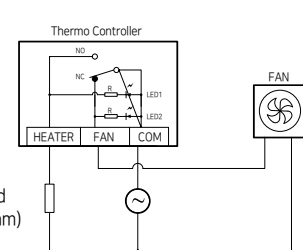
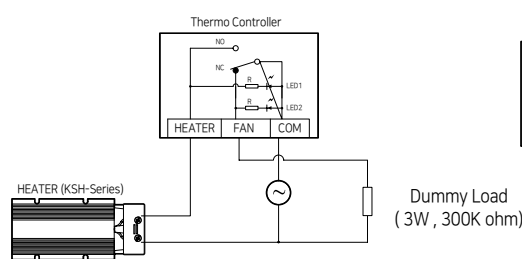
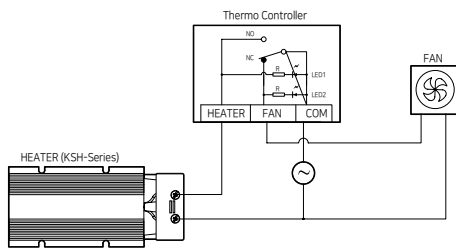

* Heater or Fan Single operation caution : User shall have dummy load (more than 3W, 300K ohm) as above circuit diagram.
 * If the dummy load is not connected it is cause of wrong lamp operation.

Panel Cut-Out

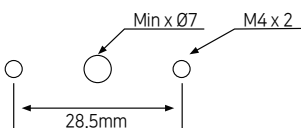

Rev. 2/14

Data subject may change without notice.

www.kacon.co.kr

Industrial Controls Catalog

IV - 91

KACON