

LSS

Disk Load Cell



Description

LSS is a Stainless steel disk type load cell. It is suitable for Hopper, Tank, Silo Scale

Specifications

Capacity(R.L.)	tf	1, 2, 3, 5, 10, 20, 30, 50
Rated Output	mV / V	2.0 ± 0.0075
Zero Balance	mV / V	0.0 ± 0.020
Accuracy Class	-	-
Non-Linearity	% R.O.	≤0.03
Hysteresis	% R.O.	≤0.03
Combined Error	% R.O.	≤0.03
Repeatability	% R.O.	≤0.02
Creep for 30min.	% R.O.	≤0.03
Return for 30min.	% R.O.	≤0.03
Resolution	-	≤1/3000
Division	mV / V	0.00067
Temperature Effect on	-Zero Value -Output Value	%/10°C %/10°C
		≤0.03 ≤0.03
Excitation	-Recommended	V
	-Maximum	V
		10 15
Resistance	-Input	Ω
	-Output	Ω
	-Insulation	MΩ
		350 ± 3.5 350 ± 3.5 > 2000
Compensated Temperature Range	°C	-10 to +40
Operating Temperature Range	°C	-30 to +80
Material & Plate	-	Stainless steel
Cable Specification	-	Ø8 X 4P X 5m (10m) (PVC) Explosion-proof (Urethane)
Safety Overload	% R.L.	150

Features

- ▶ Tensile, Compression type
- ▶ Stainless Steel
- ▶ Hermetically sealed structure
- ▶ Designed according to IP68

Option

- ▶ Tensile type Accessories (Rod End Bearing Type)
- ▶ Compression type Accessories (Load button, ball type)
- ▶ LSS-EXP / intrinsically safe explosion proof (Ex ia II C T4)
- ▶ LSS-EXP-D / Explosion proof (Ex d IIC T4)
- ▶ LSS-EXP-TD / dust proof explosion proof (Ex tD A21 T135 °C IP68)
- ▶ LSS-NR (CE certified)

Application

- ▶ Hopper, tank, silo scale
- ▶ Tensile / Compression Tester

Dimensions

▶ LSS

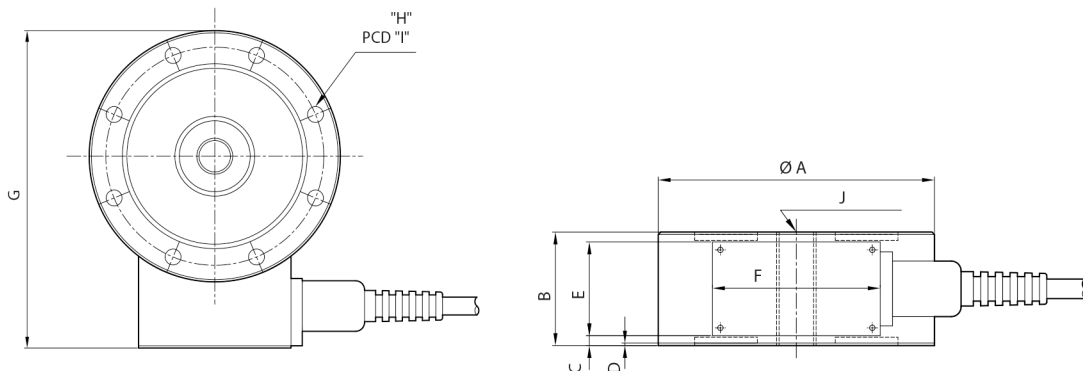

Capa.	A	B	C	D	E	F	G	H	I	J	Cable(m)
1-3tf	112	46	4	1	38	68	141.5	8-ø7.1	97.2	M16X2	5
5tf	120	46	4				150.4	8-ø9	103.2	M18X1.5	5
10tf	138	60	11				170	8-ø11	117.6	M24X2	5
20-30tf	184	80	21				218.5	8-ø14	157.6	M39X2	10
50tf	200	60	7.8				235	12-ø14.5	170	M45X3	10

Disk Type
Noise Resistance
Explosion Proof
Digital
Accessory