

Safety Cover Terminal Block H Type

KTB1 Series



Part Number Description

KTB1 - **①** **②** - c

① Rated Current	060 : 60A	100 : 100A	150 : 150A	200 : 200A
② Number of Poles	03 : 3Pole	04 : 4Pole		

General Specification

Description	KTB1-060	KTB1-100	KTB1-150	KTB1-200	
Rated Current	60A	100A	150A	200A	
Rated Voltage	Max. 600VAC				
Insulation Resistance	1,000MΩ min.(at 500VDC)				
Dielectric Strength	2,500VAC 1min.				
Material	Body	Flame retardant phenol resin (V0), black		Flame retardant phenol resin (HB), black	
	Cover	PC, Clear			
	Terminal	1st grade brass			
	Name Plate	PVC (pearl white)			

☞ Ambient temperature : -20 ~ 60°C

The specification of the connection Terminal

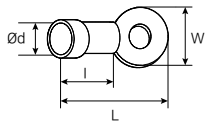





Description	KTB1-060	KTB1-100	KTB1-150	KTB1-200
Terminal Bolt	M6.0	M7.0	M8.0	M8.0
W(mm)	14.5	19.5	21.5	24.5
L(mm)	35.5	45.6	50.5	50.5
l(mm)	14.5		20.0	
d	Ø6.1	Ø8.1		Ø10.1

☞ The material and the specification can be changed without notice for better quality.

Safety Cover Terminal Block H Type

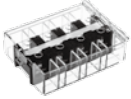

KTB1 Series

Product Selection

	Rated Current	Pole	Terminal Bolt	Order Number	Components		
					Terminal Block	Insulated wall cover	Hinged cover
	60A	3	M6.0	KTB1-06003-H	KTB1-06003	KTB1-060BC	KTB1-060A3HC
		4		KTB1-06004-H	KTB1-06004	KTB1-060BC	KTB1-060A4HC
	100A	3	M7.0	KTB1-10003-H	KTB1-10003	KTB1-100BC	KTB1-100A3HC
		4		KTB1-10004-H	KTB1-10004	KTB1-100BC	KTB1-100A4HC
	150A	3	M8.0	KTB1-15003-H	KTB1-15003	KTB1-150BC	KTB1-150A3HC
		4		KTB1-15004-H	KTB1-15004	KTB1-150BC	KTB1-150A4HC
	200A	3	M8.0	KTB1-20003-H	KTB1-20003	KTB1-200BC	KTB1-200A3HC
		4		KTB1-20004-H	KTB1-20004	KTB1-200BC	KTB1-200A4HC

※ When ordering with the order code, it is shipped with a protective cover attached. (Terminal block + Insulated wall cover + Hinged cover)

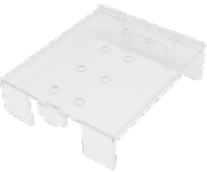
Accessory

형상	구분	Part Number	Pole	Applicable terminal block
	H Type Safety cover ※Flame retardant phenol resin (V2)	KTB1-060A3HC	3	KTB1-06003
		KTB1-060A4HC	4	KTB1-06004
		KTB1-100A3HC	3	KTB1-10003
		KTB1-100A4HC	4	KTB1-10004
		KTB1-150A3HC	3	KTB1-15003
		KTB1-150A4HC	4	KTB1-15004
		KTB1-200A3HC	3	KTB1-20003
		KTB1-200A4HC	4	KTB1-20004
	H Type Safety cover ※Flame retardant phenol resin (V2)	KTB1-060BC	4	KTB1-06003 KTB1-06004
		KTB1-100BC	4	KTB1-10003 KTB1-10004
		KTB1-150BC	4	KTB1-15003 KTB1-15004
		KTB1-200BC	4	KTB1-20003 KTB1-20004

※ When using the BC cover, if the terminal block and the number of poles are different, separate the BC cover and connect it with the desired number of poles.

Dimension

unit : mm

Top View

Side View

Front View

KTB1-06003-H

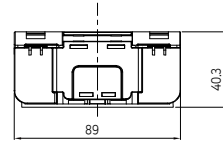
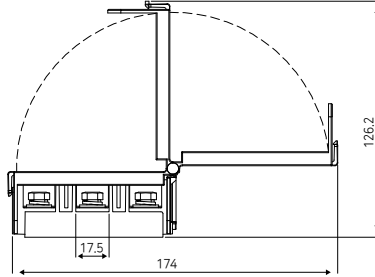
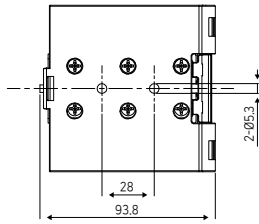

KTB1-06004-H

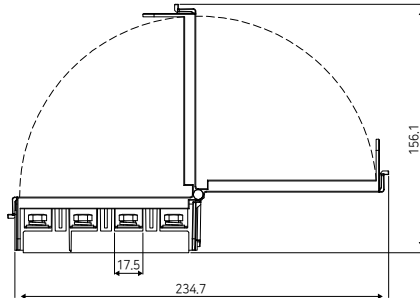
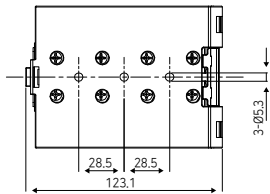

KTB1-10003-H

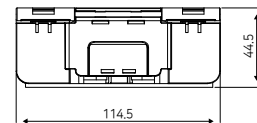
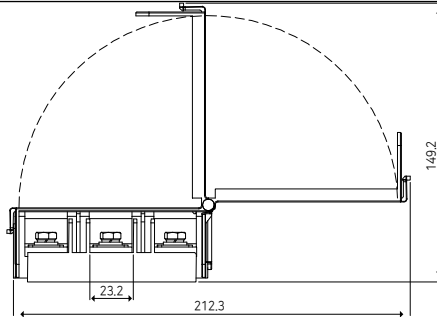
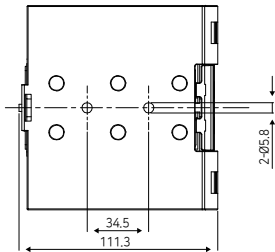

KTB1-10004-H

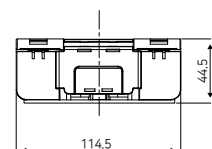
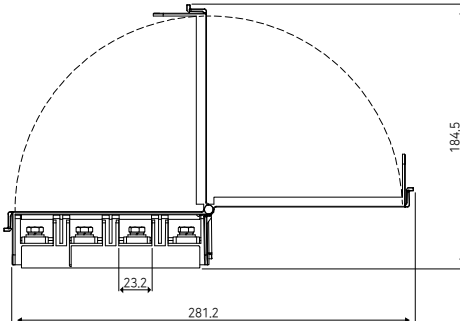
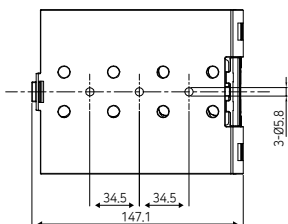

Rev. 2/14

Data subject may change without notice.

www.kacon.co.kr

Industrial Controls Catalog

IV - 33

Safety Cover Terminal Block H Type

KTB1 Series

Dimension

unit : mm

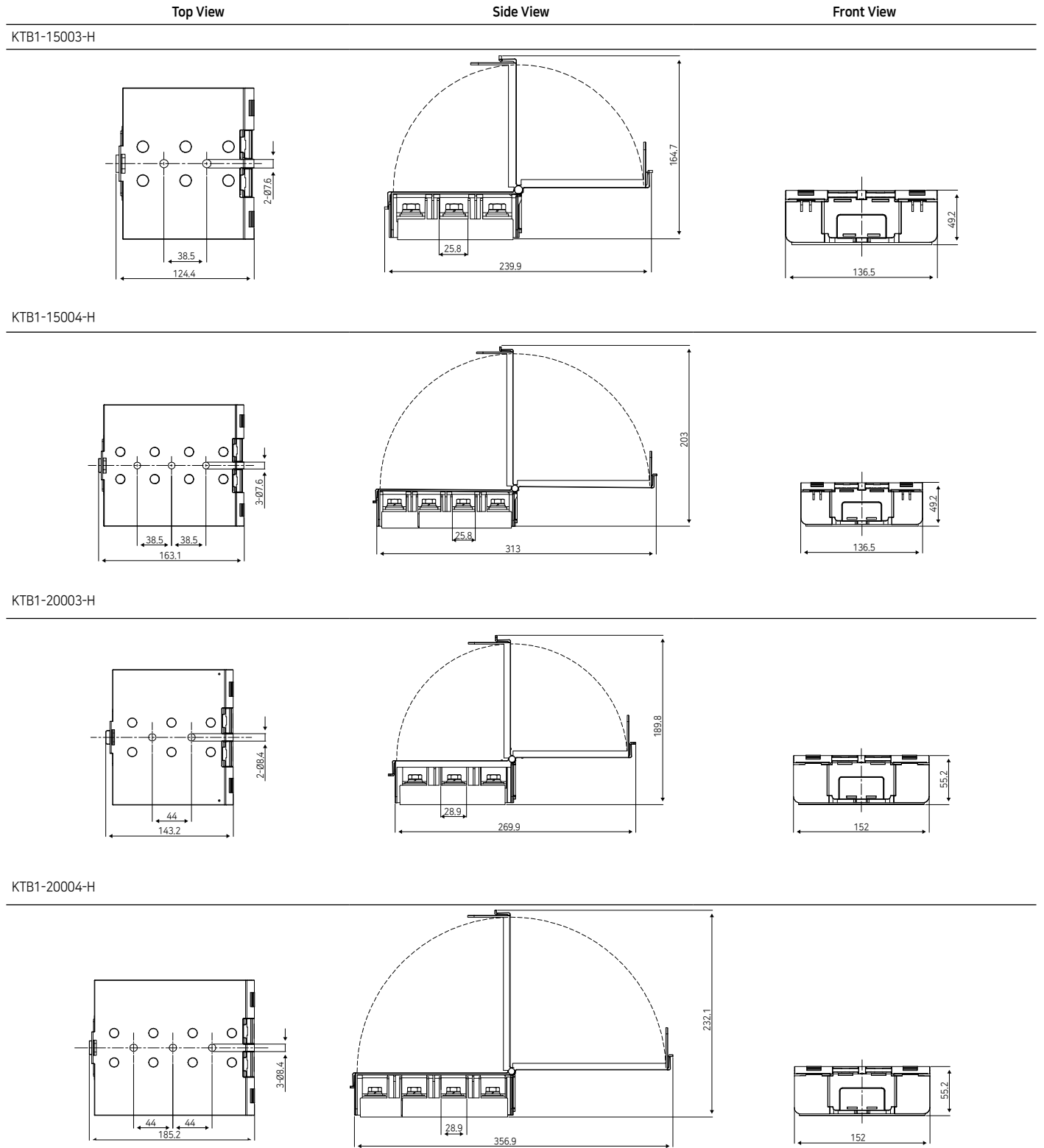

Dimension

unit : mm

Accessory

H Type protection cover

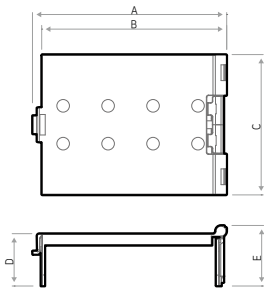

Part Number	A	B	C	D	E
KTB1-060A3HC	94.5	85.0	89.0	33.0	38.0
KTB1-060A4HC	123.0	117.5	89.0	33.0	38.0
KTB1-100A3HC	113.0	107.5	114.5	37.5	42.5
KTB1-100A4HC	147.0	141.5	114.5	37.5	42.5
KTB1-150A3HC	124.0	118.5	136.5	41.0	46.0
KTB1-150A4HC	163.0	157.0	136.5	41.0	46.0
KTB1-200A3HC	143.0	135.0	152.0	47.5	53.5
KTB1-200A4HC	187.0	179.0	152.0	47.5	53.5

C Type protection cover

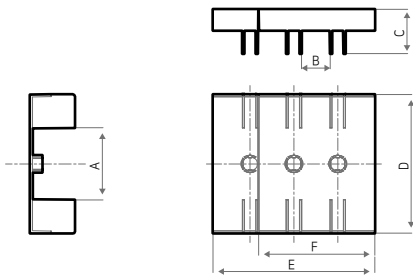

Part Number	A	B	C	D	E	F
KTB1-060BC	44	17.5	30.6	81	104	74.4
KTB1-100BC	55.2	23.2	33.6	105	125	90.8
KTB1-150BC	66.8	25.8	37.1	126	145	104.1
KTB1-200BC	73	28.9	45.2	141	165	118.6

Safety Cover Terminal Block H Type

KTB1 Series

Assembly sequence

※ It is shipped with the protective cover attached at the factory.

1. Attach the lower part hook (❶) of the cover side to the lower side (❶) of the terminal block and push the lower part of the cover to fasten the lower part hook.

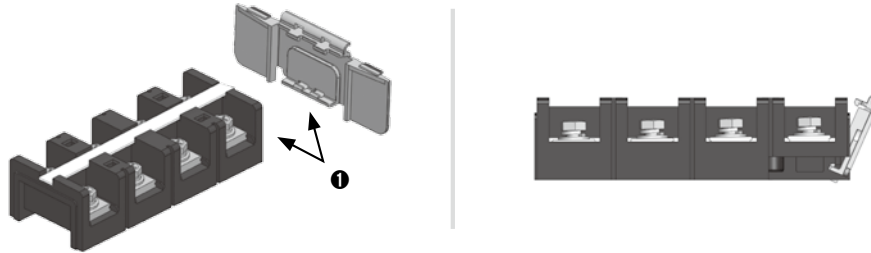

2. Push the upper part of the hook to complete the side cover fastening.



3. Insert the upper cover bar (❷) into the upper side groove (❶) of the side cover to complete the tightening.

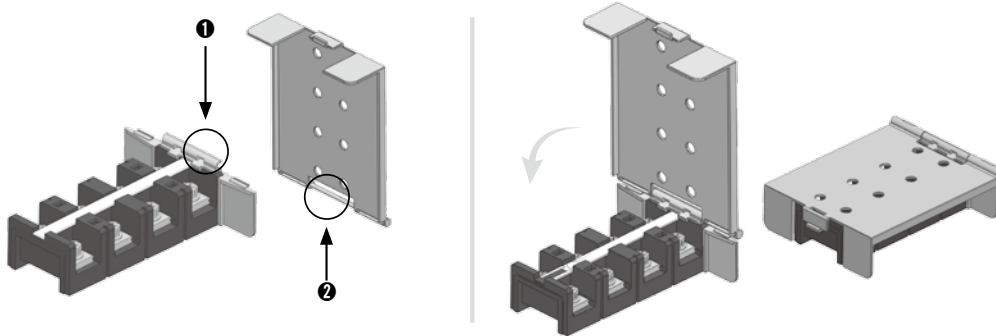

4. Attach the lower cover to the lower part of the terminal block where the upper cover is connected

