

# WBKL

## Canister Load Cell



### Features

- ▶ Compressed type
- ▶ Hermetically sealed structure
- ▶ Designed according to P68

### Option

- ▶ Truckscale Accessory SET

### Application

- ▶ Hopper, Silo, Tank Scale
- ▶ Truck scale

### Description

WBKL is a Canister type load cell of stainless steel / steel. Compressed type load cells with a sealed structure are suitable for harsh industrial environments such as hoppers, tanks, silos, and truck scales.

### Specifications

Capacity(R.L.)		tf	10, 20, 25, 30, 50, 100	
Rated Output		mV / V	2.0 ± 0.005	
Zero Balance		mV / V	0.0 ± 0.020	
Accuracy Class		-	A	B
Non-Linearity		% R.O.	≤ 0.02	≤ 0.03
Hysteresis		% R.O.	≤ 0.02	≤ 0.03
Combined Error		% R.O.	≤ 0.02	≤ 0.03
Repeatability		% R.O.	≤ 0.01	≤ 0.02
Creep for 30min.		% R.O.	≤ 0.017	≤ 0.03
Return for 30min.		% R.O.	≤ 0.017	≤ 0.03
Resolution		-	≤ 1/5000	≤ 1/3000
Division		mV / V	0.0004	0.00067
Temperature Effect on	-Zero Value	%/10°C	≤ 0.014	≤ 0.03
	-Output Value	%/10°C	≤ 0.011	≤ 0.03
Excitation	-Recommended	V	10	
	-Maximum	V	15	
Resistance	-Input	Ω	350 ± 3.5	
	-Output	Ω	350 ± 3.5	
	-Insulation	MΩ	> 2000	
Compensated Temperature Range		°C	-10 to +40	
Operating Temperature Range		°C	-40 to +80	
Material & Plate		-	Stainless Steel	
Cable Specification		-	Ø8 x 4P x 12M (PVC)	
Safety Overload		% R.L.	150	

### Dimensions

▶ WBKL (10tf~30tf)

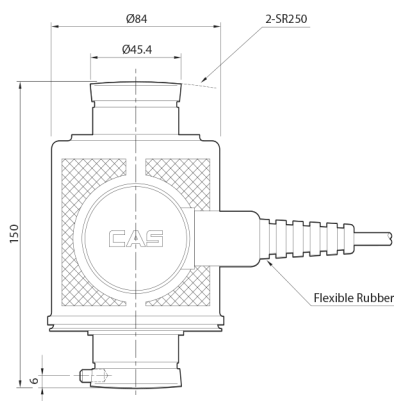

▶ WBKL (50tf~100tf)

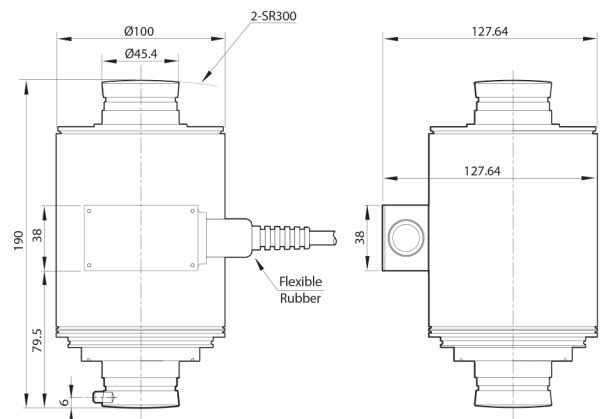

Accessory Dimensions

► 10tf-30tf

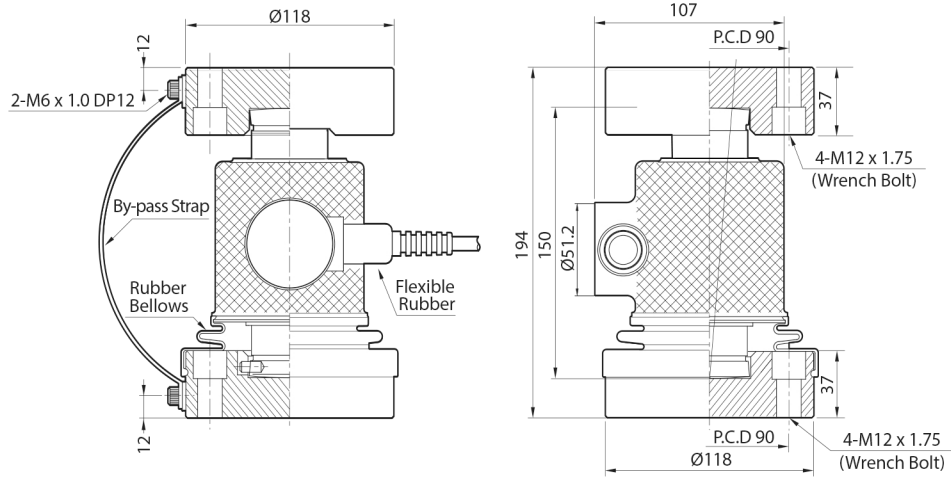

► 50tf-100tf

